

INSTALLATION PROCEDURE

Double Adjustable Rod Type

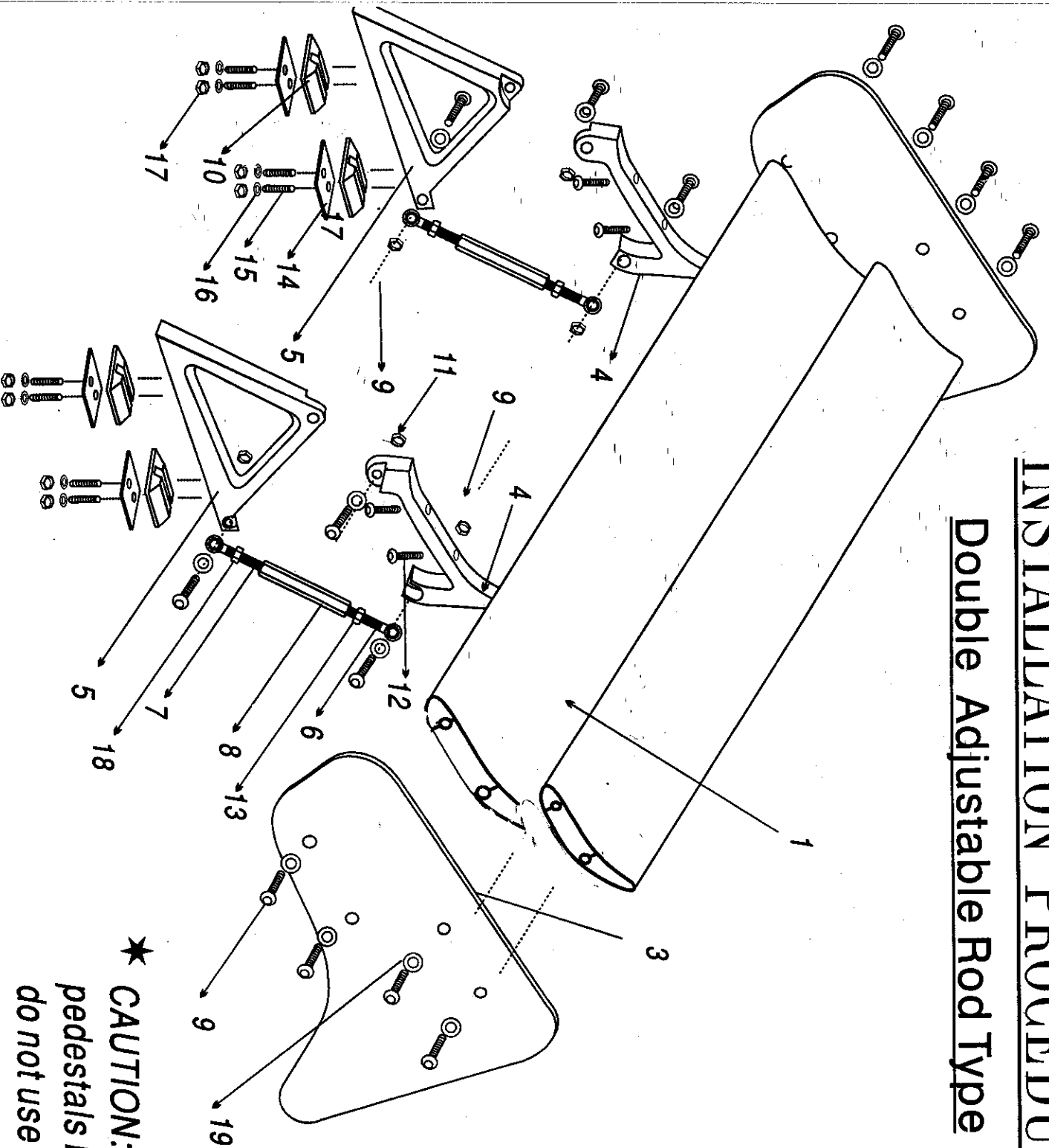
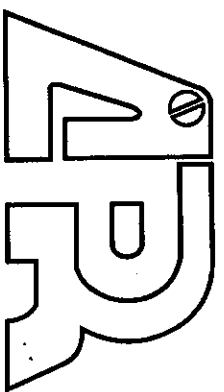

No	Component Part	QTY
1	Main Wing	2
3	Side Wing for L/R	2
4	Upper stand L/R	2
5	Bottom stand L/R	2
6	Screw Rod-left	2
7	Screw Rod-Right	2
8	Adjustable Rod	2
9	M8 Screw x20mm	14
10	Flat Bracket(small)	4
11	M8 Cap	6
12	M6 Screw x25mm	4
13	NUT-L	2
14	3M sticker for J9	4
15	M6 Screw x40mm	8
16	Washer(M6)	8
17	M6 Cap	8
18	NUT-R	2
19	Washer (M8)	14
	3mm Hexagonal driver	1
	4mm Hexagonal driver	1
	5mm Hexagonal driver	1

★ **CAUTION:** Please loose all screws on pedestals before adjusting
do not use any tools to force